

- 1
- 2
- 3
- 4
- 5
- 6
- 7
- 8
- 9
- 10
- 11
- 12
- 13
- 14
- 15
- RH

MATERIAL

Glass-fibre reinforced polyamide based (PA) technopolymer, black colour, matte finish.

FLAT PACKING RING

NBR synthetic rubber.

MAXIMUM CONTINUOUS WORKING TEMPERATURE

212°F (100°C).

TECHNICAL DATA

The tightening torque indicated in the table guarantees an optimal tightness, keeping the packing ring in the correct position.

ACCESSORIES ON REQUEST

TN. plugs are suitable for mounting aluminium plates with graphic symbols type MH. (see page 1302).



ELESA Original design

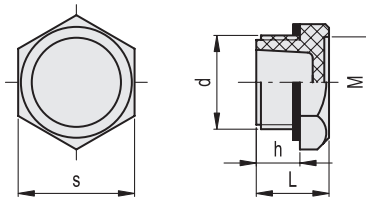

INCH

Code	Description	d	h	s	L	M	Tightening torque [ft·lb]	⚖
958295	TN.1/4 NPT	1/4 NPT	0.35	0.75	0.63	0.59	3÷4	0.01
958296	TN.3/8 NPT	3/8 NPT	0.35	0.87	0.63	0.67	6÷7	0.01
958297	TN.1/2 NPT	1/2 NPT	0.43	1.02	0.71	0.81	6÷7	0.02
958298	TN.3/4 NPT	3/4 NPT	0.47	1.26	0.79	0.98	7÷9	0.03